



91 Terry Street Tempe NSW

2 1

The verve and vibrancy in which this traditional Victorian terrace has been given an irresistible contemporary persona is significantly complemented by its emphasis on indoor outdoor enjoyment. Ideally positioned close to Sydenham Station, Tillman Park and schools, this home will sure impress the most astute buyer.

Price : \$ 1,135,000
Land Size : 146 sqm
View : <https://www.thepropertysellers.com.au/sale/nsw/inner-west/tempe/residential/house/5927448>

- ? Renovated throughout with a clear focus on quality and detail
- ? Two double carpeted bedrooms with floor to ceiling wardrobes
- ? Central family bathroom with separate bath and walk in shower
- ? Large Caesarstone gas kitchen with Delonghi appliances
- ? Open plan living and dining room flowing to covered deck
- ? North facing low maintenance yard with storage shed
- ? Ducted reverse cycle air conditioning, bamboo floors,



Louise Mitchell
02 9560 0088



FLOOR PLAN

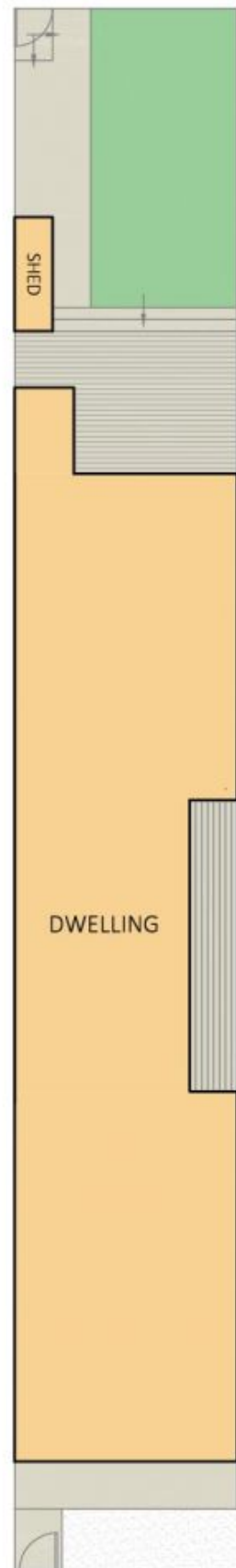

SITE PLAN

