



**32 Edwin Street Tempe NSW**

3 1

A fresh update has given this classic period home a new lease on life, creating a great home for the modern family and entertainer. It is light and airy throughout and offers a smartly presented layout with flexibility and a clean interior design. If convenience and lifestyle is high on your list, you will be instantly impressed by its popular and highly convenient location.

**Price** : \$ 1,350,000  
**Land Size** : 218 sqm  
**View** : <https://www.thepropertysellers.com.au/sale/nsw/inner-west/tempe/residential/house/5927538>

- ? North east facing semi detached home
- ? Patterned ceilings, timber floors, plantation shutters
- ? 3 large bedrooms all with built in robes
- ? Central living room with feature fireplace
- ? Modern eat in gas kitchen with dishwasher
- ? Chic airy bathroom with bath/shower
- ? Large covered entertaining deck with TV
- ? Private low maintenance yard with frangapani tree
- ? Huge multipurpose storage shed/workshop



**Louise Mitchell**  
**02 9560 0088**

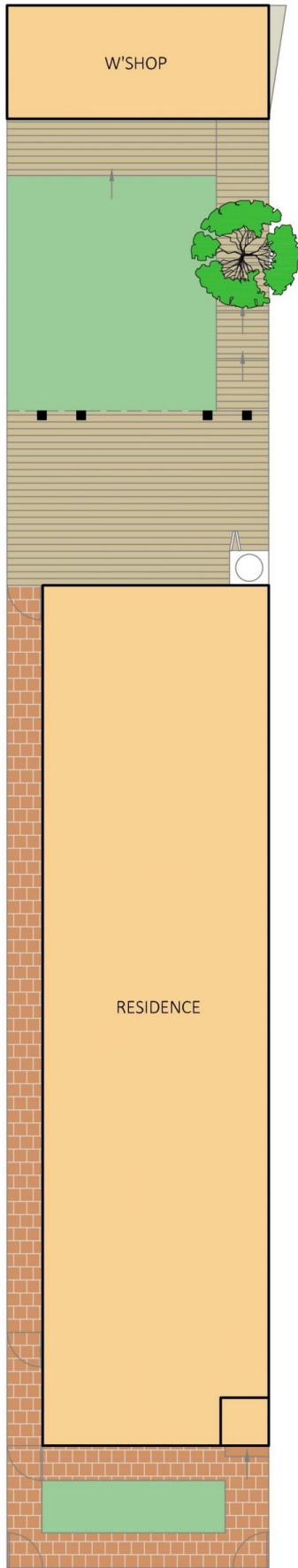

SITE PLAN



AT REAR

