

## 23 Edwin Street Tempe NSW

2 1

Made memorable by a street presence where the authenticity of the period is unmistakable, this charming home conveys classical character with the added appeal of room to further improve when required. The homes bedrooms retain the original romance of airy ceilings before polished timber hallway floors lead to the central lounge that glows in the ambience of filtered light. With a modern stone kitchen, this home offers scope to add value in the future.

**Price** : \$ 1,610,000  
**Land Size** : 228.7 sqm  
**View** : <https://www.thepertysellers.com.au/sale/nsw/inner-west/tempe/residential/house/6860659>

- ? Positioned in one of the suburb's best streets
- ? Gorgeous street appeal with picket fence & soothing colours
- ? Double bedrooms w/ patterned ceilings & timber floors
- ? Wide living room w/ feature fireplace & plantation shutters
- ? Neat central bathroom w/ bath, linen cupboard
- ? Stone gas kitchen w/ Smeg appliances, dining zone



**Louise Mitchell**  
02 9560 0088

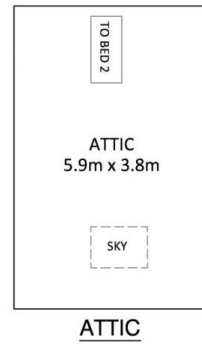
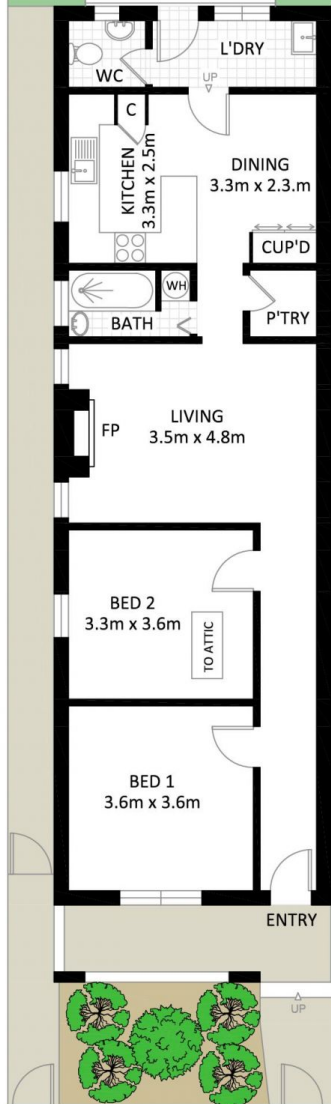
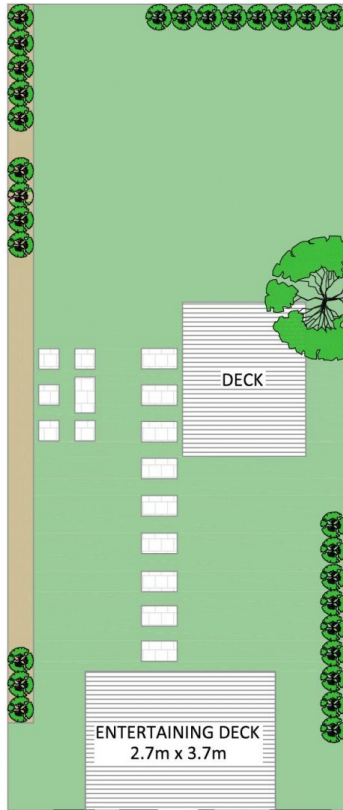

**GROUND FLOOR**