

91 Terry Street Tempe NSW

2 1

Extended design, eternal charm and premium features highlight the appeal of this Victorian home presenting a ready-to-enjoy lifestyle of quality, privacy and city-edge convenience. Ideally positioned close to Sydenham Station, Tillman Park and schools, this home will sure impress the most astute buyer.

Price : \$ 1,631,000
Land Size : 146 sqm
View : <https://www.thepertysellers.com.au/sale/nsw/inner-west/tempe/residential/house/7940907>

- ? Renovated throughout with a clear focus on quality and detail
- ? Two double carpeted bedrooms with large wardrobes
- ? Central family bathroom with separate bath and walk in shower
- ? Large Caesarstone gas kitchen with Delonghi appliances
- ? Open plan living and dining room flowing to covered deck
- ? North facing low maintenance yard with storage shed
- ? Ducted reverse cycle air conditioning, bamboo floors, attic storage



Louise Mitchell
02 9560 0088



FLOOR PLAN

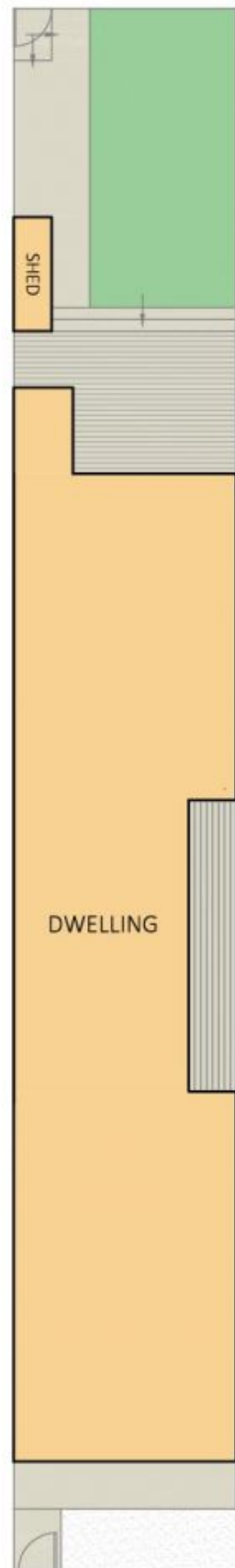

SITE PLAN